

# Welcome to **SERENGETI** **NORTH WILDERNESS CAMP**

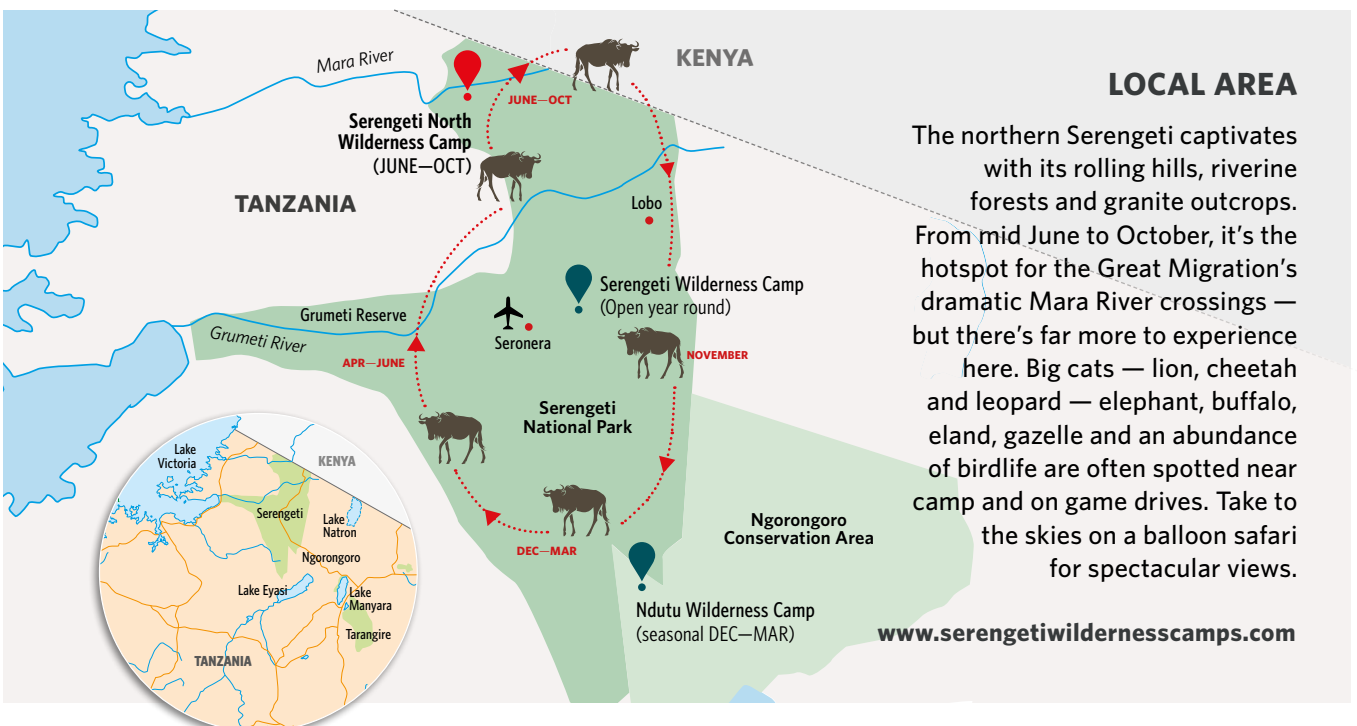

*Your front-row seat to the migration*

Our seasonal Serengeti North Wilderness Camp is quietly tucked away from the crowds, yet perfectly positioned near key Mara River crossing points. By moving with the herds, we place ourselves in some of the top game viewing areas in the park. The tented camp offers a relaxed, authentic safari experience with personalised service, delicious food and the warm hospitality Tanzania is known for. Thoughtfully designed with sustainability in mind, this eco-conscious camp runs on solar power and features gravity-fed showers powered by an efficient solar water heating system to reduce both water and energy consumption.



## LOCAL AREA

The northern Serengeti captivates with its rolling hills, riverine forests and granite outcrops. From mid June to October, it's the hotspot for the Great Migration's dramatic Mara River crossings — but there's far more to experience here. Big cats — lion, cheetah and leopard — elephant, buffalo, eland, gazelle and an abundance of birdlife are often spotted near camp and on game drives. Take to the skies on a balloon safari for spectacular views.

[www.serengetiwildernesscamps.com](http://www.serengetiwildernesscamps.com)

## RELAX UNDER CANVAS COMFORT

Ten spacious new tents (10m x 4m) are comfortably furnished and well-spaced for added privacy. Each features a generous verandah with both an open and a cool netted sitting area – perfect for relaxing by day or night. Inside, you'll find an ensuite bathroom with a vanity basin, gravity-fed shower, and toilet. Drift off to sleep to the sounds of nature, then wake to fresh tea or coffee delivered to your tent – best enjoyed on your verandah, which features with a comfy day bed, chairs and a table. The family tent is ideal for families with young children (min age 6 years).

## YOUR STAY MATTERS

A portion of every night spent on safari with us contributes to our Sustainable Tourism Fund, supporting projects like the [Kilimanjaro Tree Project](#) and [The Serengeti De-snaring Programme](#).

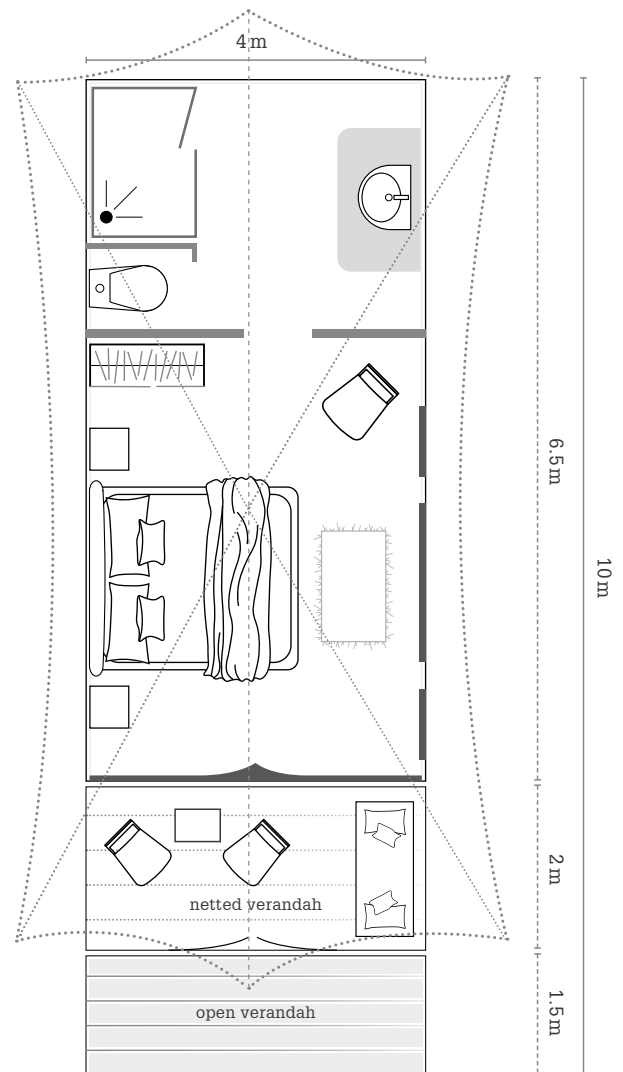

### AT A GLANCE

Kogatende, North Serengeti



30 minute drive from Kogatende airstrip



Full day drive from central Serengeti

### Seasonal Camp



Open mid-June to October for peak river crossing season



**Open game drive vehicle** — available for fly-in safari guests

### Dining Tent



Enjoy fresh, seasonal dishes — often served al fresco — with wine, beer and soft drinks included

### Lounge Tent



Relax in the lounge tent with a well-stocked bar and library of maps, books and games

### Campfire



Enjoy sundowners and snacks by the fire, surrounded by the bush's evening chorus

### WiFi



Enjoy free WiFi throughout the camp

### Recharging Facilities



USB charging in tents, plus a central station in the lounge



A **dedicated tent** with extra charging and editing space can be set up for photo groups



“ Our 4 days with you was the best African experience we have ever had. The drives were far beyond our expectation and the camp was amazing, immersed in the African bush. Truly it was everything we could have dreamt of and more. ”



[www.serengetiwildernesscamps.com](http://www.serengetiwildernesscamps.com)

**GPS COORDINATES**

-1.676494, 34.903209

**WHAT THREE WORDS LOCATION**

///castanets.reviewing.rambling



**CONTACT DETAILS**

**TANZANIA** — Accommodation bookings only

- ✉ [reservations@serengetiwildernesscamps.com](mailto:reservations@serengetiwildernesscamps.com)
- ☎ +255 786 642 466 or +255 754 842 466
- 🌐 [www.serengetiwildernesscamps.com](http://www.serengetiwildernesscamps.com)

**Safari bookings**

- ✉ [reservations@wildfrontiers.com](mailto:reservations@wildfrontiers.com)
- ☎ +27 (11) 702 2035

f: [SerengetiWildernessCamps](https://www.facebook.com/SerengetiWildernessCamps)  
i: [serengeti\\_wilderness\\_camps\\_](https://www.instagram.com/serengeti_wilderness_camps_)

